

UNITED STATES DEPARTMENT OF THE INTERIOR  
 NATIONAL PARK SERVICE  
 NATIONAL REGISTER OF HISTORIC PLACES  
 REGISTRATION FORM

OMB NO. 1024-0018, NPS FORM

This form is for use in nominating or requesting determinations of eligibility for individual properties or districts. See instructions in Guidelines for Completing National Register Forms (National Register Bulletin 16). Complete each item by marking "x" in the appropriate box or by entering the requested information. If an item does not apply to the property being documented, enter "N/A" for "not applicable." For functions, styles, materials, and areas of significance, enter only the categories and subcategories listed in the instructions. For additional space use continuation sheets. Type all entries.

**1. Name of Property**

historic name The Drury Cottage  
 other names/site number \_\_\_\_\_

**2. Location**

street & number 29 Bloomingdale Avenue | | not for publication  
 city, town Saranac Lake (town of Harrietstown) | | vicinity  
 state New York code NY county Franklin code 033 zip code 12983

**3. Classification**

Ownership of property	Category	Number of resources within property	
<input checked="" type="checkbox"/> private	<input checked="" type="checkbox"/> building(s)	Contributing	Noncontributing
<input type="checkbox"/> public-local	<input type="checkbox"/> district	<u>1</u>	_____ buildings
<input type="checkbox"/> public-State	<input type="checkbox"/> site	_____	_____ sites
<input type="checkbox"/> public-Federal	<input type="checkbox"/> structure	_____	_____ structures
	<input type="checkbox"/> object	_____	_____ objects
		<u>1</u>	<u>0</u> Total

Name of related multiple property listings: Village of Saranac Lake  
Multiple Documentation Form

Number of contributing resources previously listed in the National Register 0

**4. State/Federal Agency Certification**

As the designated authority under the National Historic Preservation Act of 1966, as amended, I hereby certify that this  nomination  request for determination of eligibility meets the documentation standards for registering properties in the National Register of Historic Places and meets the procedural and professional requirements set forth in 36 CFR Part 60. In my opinion, this property  meets  does not meet the National Register criteria.  See continuation sheet.

*William A. Stokun* 4/9/92  
 Signature of certifying official Date  
 Deputy Commissioner for Historic Preservation  
 State or Federal agency and bureau

In my opinion, the property  meets  does not meet the National Register criteria.  
 See continuation sheet.

Signature of commenting or other official \_\_\_\_\_ Date \_\_\_\_\_  
 State or federal agency and bureau \_\_\_\_\_

**5. National Park Service Certification**

I hereby, certify that this property is:  
 entered in the National Register.  
 See continuation sheet.  
 determined eligible for the National Register.  see continuation sheet.  
 determined not eligible for the National Register.  
 removed from the National Register.  
 other, (explain:)

Signature of keeper \_\_\_\_\_ Date of Action \_\_\_\_\_

---

**6. Function or Use**

---

Historic Function  
(enter categories from instructions)  
Domestic/single dwelling  
Health Care/sanitarium  

---

---

Current Functions  
(enter categories from instructions)  
Domestic/multiple dwellings  

---

---

---

**7. Description**

---

Architectural Classification  
(enter categories from instructions)  
Late 19th & early 20th Century  
American Movements: Bungalow/Craftsman  

---

Materials(enter categories from instructions)  
foundation Fieldstone  
walls Masonry/Stucco  
roof Asphalt  
other 

---

---

---

Describe present and historic physical appearance.

The Drury cottage is located on the south side of Bloomingdale Avenue in the incorporated village of Saranac Lake, Franklin County. Bloomingdale Avenue comprises a mix of commercial and residential buildings. The house is situated on a small village lot and faces north onto Bloomingdale Avenue. The lot slopes rather steeply to the south, with an alley leading to a commercial parking lot along its western border. There are no other contributing or non-contributing features on the property.

The Drury cottage is a two and one-half story, frame dwelling, set atop a cut stone foundation and surmounted by gable roof clad in asphalt shingles. Fenestration is generally irregular, containing paired and individual six-over-one sash of varying sizes. Wall surfaces throughout are finished in stucco with simple wooden trim. The a large cobblestone chimney rises up on the western side of the house.

Drury cottage's principle (north) facade is dominated by a two-story, three-bay cobblestone porch, with fan transoms over triple casement windows in the first floor arches and sliding diamond-paned panels in the porch openings above. Oval stucco medallions are centered above each arch.

The rear (south) elevation of the residence is dominated by a number of wings and additions. A large one and one-half story wing erected atop a stone foundation and stuccoed to match the main block of the house appears to have been built as part of the original structure. A one and one-half story garage addition is located on the western side of the rear wall to the west of the principle wing. A shed-roofed porch, now partially enclosed, extends off the south end of the house (to the rear). This porch has sliding two-over-two glass panels and is supported on a concrete block foundation. A second-story porch just west of that wing has paired six-over-one sash windows, and may also have functioned as curing porch.

**8. Statement of Significance**

Certifying official has considered the significance of this property in relation to other properties:         nationally     statewide     locally

Applicable National Register Criteria     A     B     C     D

Criteria Considerations                     A     B     C     D     E     F     G

Areas of significance	Period of Significance	Significant Dates
<u>Health/Medicine</u>	<u>c.1910-c.1940</u>	<u>c.1910</u>
_____	_____	_____
_____	_____	_____

State significance of property, and justify criteria, criteria considerations, and areas and periods of significance noted above.

The Drury Cottage is architecturally significant as a representative example of residential cure architecture in the village of Saranac Lake. Built c.1912, the residence features a cobblestone cure porch, the only such example in the village. The porch and the cobblestone chimney were most likely the work of Pietro Tanzini, a local master stonemason, who may also have done the stucco work. Tanzini came from Italy with his family to Saranac Lake to install the Italian-made alter in the second St. Bernard's Roman Catholic church. He remained in the area and he made a specialty of cobblestone masonry work.

The Drury Cottage was built c. 1912 by Merton Drury, a livery operator. The Drury family may have taken tuberculosis patients as boarders; the house is marked on a 1917 health survey map as being occupied by tuberculous individuals. By 1926, it was a registered private sanatorium operated as a boarding cottage by Mrs. Theresa Kearney.

The cure cottages of Saranac Lake were predominantly built between the years of 1870 and 1930 and represent almost every housing type popular in the late Nineteenth and early Twentieth century. They represent vernacular expressions of architectural styles which include Italianate, Queen Anne, Colonial Revival, Tudor Revival, and bungalow stylistic features. The majority of the cottages which remain were built between 1890 and 1930.

The most common cure cottages are vernacular expressions of the Queen Anne and Colonial Revival styles, with multiple gables, balloon frame construction, decorative wooden architectural detail, multiple windows of various sizes and shapes, and associated porches or verandas. Glass-enclosed porches, used for the curing of tuberculosis patients, are the most salient feature of the cure cottage. They can be found on local structures built long after porches had gone out of fashion elsewhere.

[X] see continuation sheet

United States Department of the Interior  
National Park Service

The Drury Cottage  
29 Bloomingdale Avenue  
Saranac Lake, Franklin County, NY

NATIONAL REGISTER OF HISTORIC PLACES  
CONTINUATION SHEET

Section number 8 Page 2

---

Cure cottages are structures that can be commercial, residential or institutional in scale and expression. Many were built specifically to function as private commercial sanatoria, multiple unit dwellings, boarding houses, or private homes. Equally large numbers of cure cottages were adapted for that use from vernacular single family dwellings. All cure cottages display certain architectural features which were necessary for specific functions in the process of curing tuberculosis outdoors. Whether added at a later date or incorporated into the original building design, these features can include multiple-storied cure porches, sliding glass panels, call bells and wider-than-usual doorways without sills.

The Drury cottage, despite the accretion of several rear additions during the period of significance, retains a sufficient degree of integrity of materials, design, craftsmanship, feeling, location, association and setting to meet the established registration requirements for this property type.

9. Major Bibliographical References

Gallos, Philip L. Cure Cottages of Saranac Lake: Architecture and History of a Pioneer Health Resort, Saranac Lake, NY: Historic Saranac lake, 1985  
New York State Census Records, 1915  
TB Society blue card, white cards

Previous documentation on file (NPS):  
[ ] preliminary determination of individual listing (36 CFR 67) has been requested  
[ ] previously listed in the National Register  
[ ] previously determined eligible by the National Register  
[ ] designated a National Historic Landmark  
[ ] recorded by Historic American Buildings Survey # \_\_\_\_\_  
[ ] recorded by Historic American Engineering Record # \_\_\_\_\_  
[ ] See continuation sheet  
Primary location of additional data:  
[X] State historic preservation office  
[ ] Other State agency  
[ ] Federal agency  
[ ] Local government  
[ ] University  
[ ] Other  
Specify repository: \_\_\_\_\_

10. Geographical Data

Acreage of property Less than one acre

UTM References

A 118 1569270 149086110      B              
Zone Easting Northing      Zone Easting Northing  
C                  D              
Zone Easting Northing      Zone Easting Northing

[ ] See continuation sheet

Verbal Boundary Description

The boundary of the Drury Cottage is shown as the heavy black outline on the accompanying map entitled "Drury Cottage, Saranac Lake, Franklin County, NY."

[ ] See continuation sheet

Boundary Justification

The boundary of the nominated property include the parcel historically associated with the property.

[ ] See continuation sheet

11. Form Prepared By

name/title Rachel Bliven, Preservation Consultant, Troy, New York  
John A. Bonafide, Program Assistant  
organization N.Y.S. Office of Parks, Rec. & Historic Preservation date September 1991  
street & number E.S.P. Agency Building 1 telephone 518-474-0479  
city or town Albany state New York zip code 12238

DRURY COTTAGE, FRANKLIN COUNTY, NY.

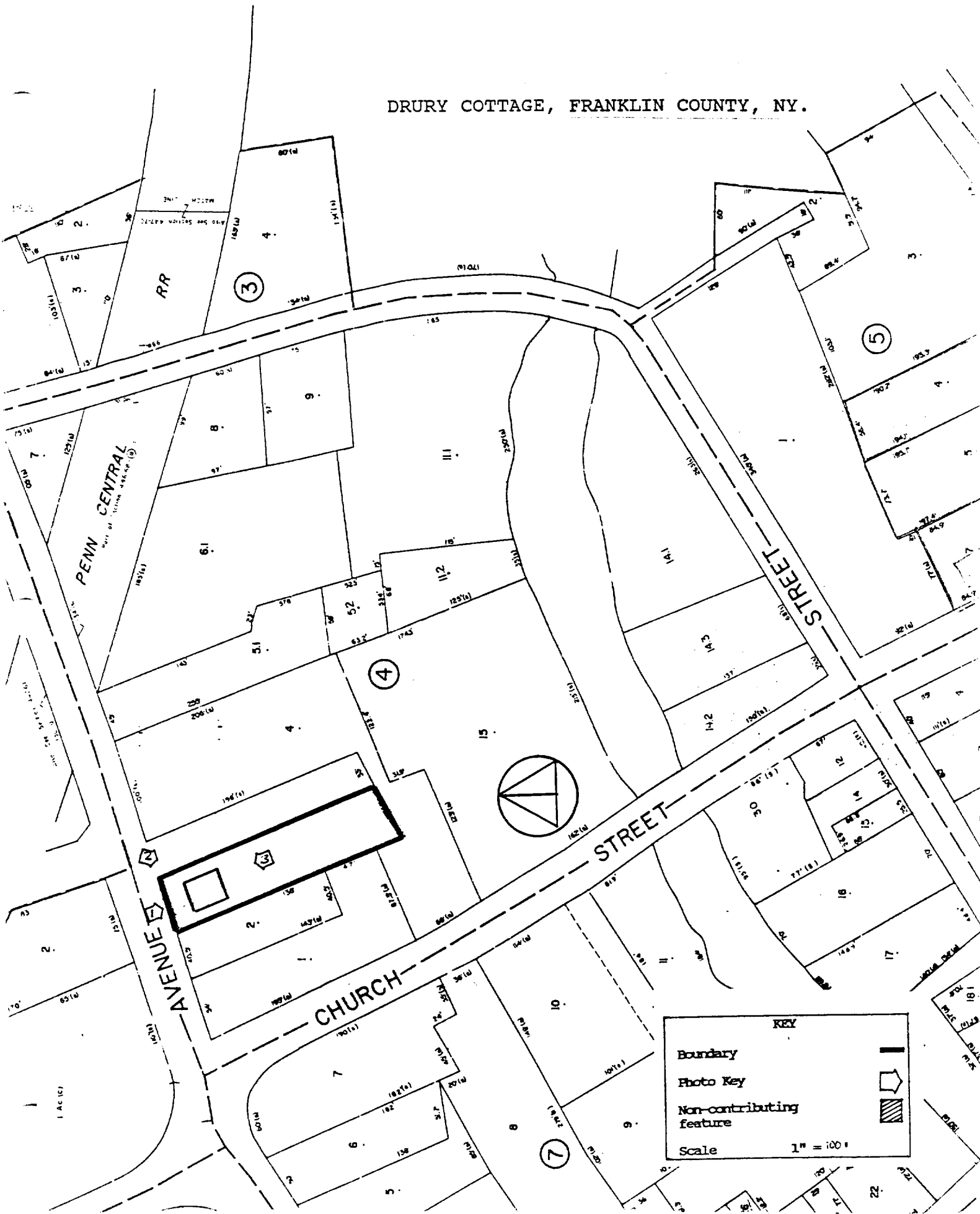

**KEY**

- Boundary
- Photo Key
- Non-contributing feature
- Scale 1" = 100'



